

Repair manual

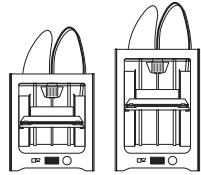

Replacing the tube coupling collet

Instructions

The tube coupling collets hold the Bowden tubes in place in the print head and feeders. It has small metal tabs on the inside that grip the Bowden tube to keep it in place.

Over time, these tabs can wear out or bend outwards. When this happens, the collet's grip on the Bowden tube becomes loose, which can negatively impact print quality. In this case it needs to be replaced. The following steps describe how to correctly replace the tube coupling collet.

Equipment/supplies needed

Tools

- None

Parts

- 1 - 4x 1069 - Tube coupling collet

Time

- 5 minutes (Including nozzle cool down time)



Disassembly



1. Remove the filament

- Remove filament from the Ultimaker 3 by navigating to "Material/PrintCore > Material [x] > Unload".

Tip: When replacing the tube coupling collet in the print head, the print material must be clear of the print head. Push the lever of the feeder up and manually pull the filament back approximately 10 cm.

2. Remove the clamp clip

- Place the print head in the front-right corner (when replacing the tube coupling collet of the print head).
- Use your fingernail to remove the old clamp clip from the tube coupling collet.

Disassembly



3. Remove the Bowden tube

- Press down on the white tube coupling collet.
- At the same time, pull the Bowden tube upwards, out of the print head or feeder.



4. Remove the old tube coupling collet

- Place your nail under the edge of the tube coupling collet.
- Pull the tube coupling out of the print head or feeder.

Reassembly

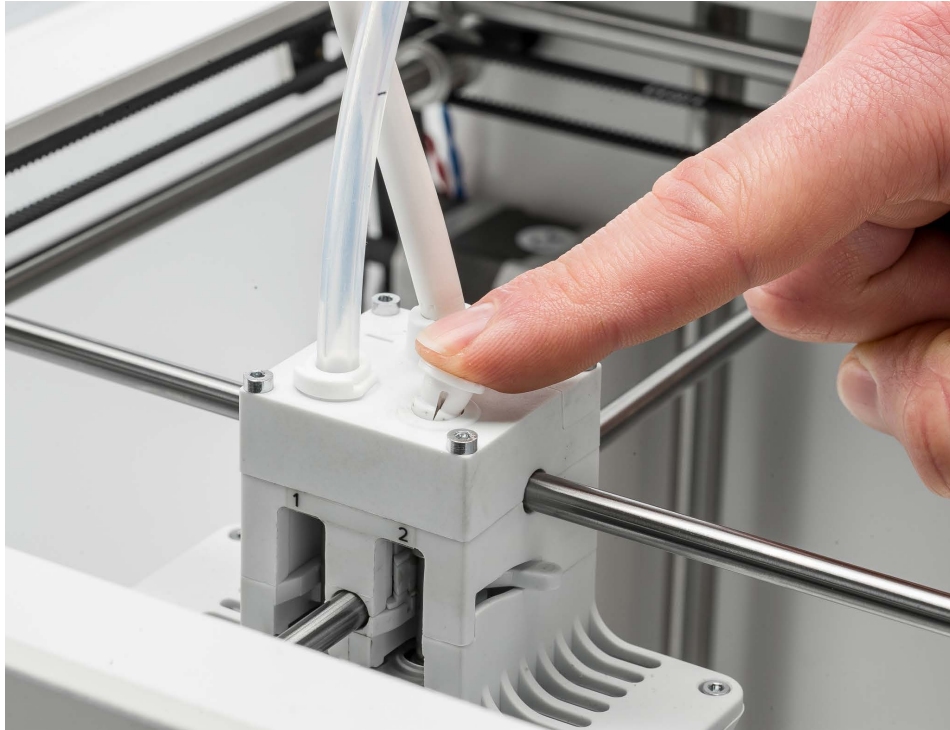

1. Insert the new tube coupling collet

- Push the four legs of the new tube coupling collet slightly inwards.
- Insert the tube coupling collet in the hole in the print head or feeder.



2. Insert the Bowden tube

- Hold the tube coupling collet down.
- At the same time, push the Bowden tube back in place.
- Place the clamp clip around the tube coupling collet to lock the Bowden tube in place.